





INTRODUCTION

A growing path of over 30 years

1990

First patents on Jewellery Machines



1997

Establishment of WORLDMEC S.r.l.



2008

Establishment of DYAMACH S.r.l.



2020

DYAMACH new offices & plant expansion



2023

DYAMACH
New Brand Identity



OUR FOUNDATIONS

- ▶ Over 25 years in the market;
- ▶ High precision mechanics in the production of diamonding machines of high technological level, outcome of many years of experience in the gold sector;
- ▶ 50 machines for different mechanical processes: milling, grinding, turning, assembling, testing, validating;
- ▶ 50 employees;
- ▶ 10÷15 millions turnover;
- ▶ Important customers from different fields;
- ▶ Supplier of parts and sub-assemblies for other milling machine producers.



WORLDMEC

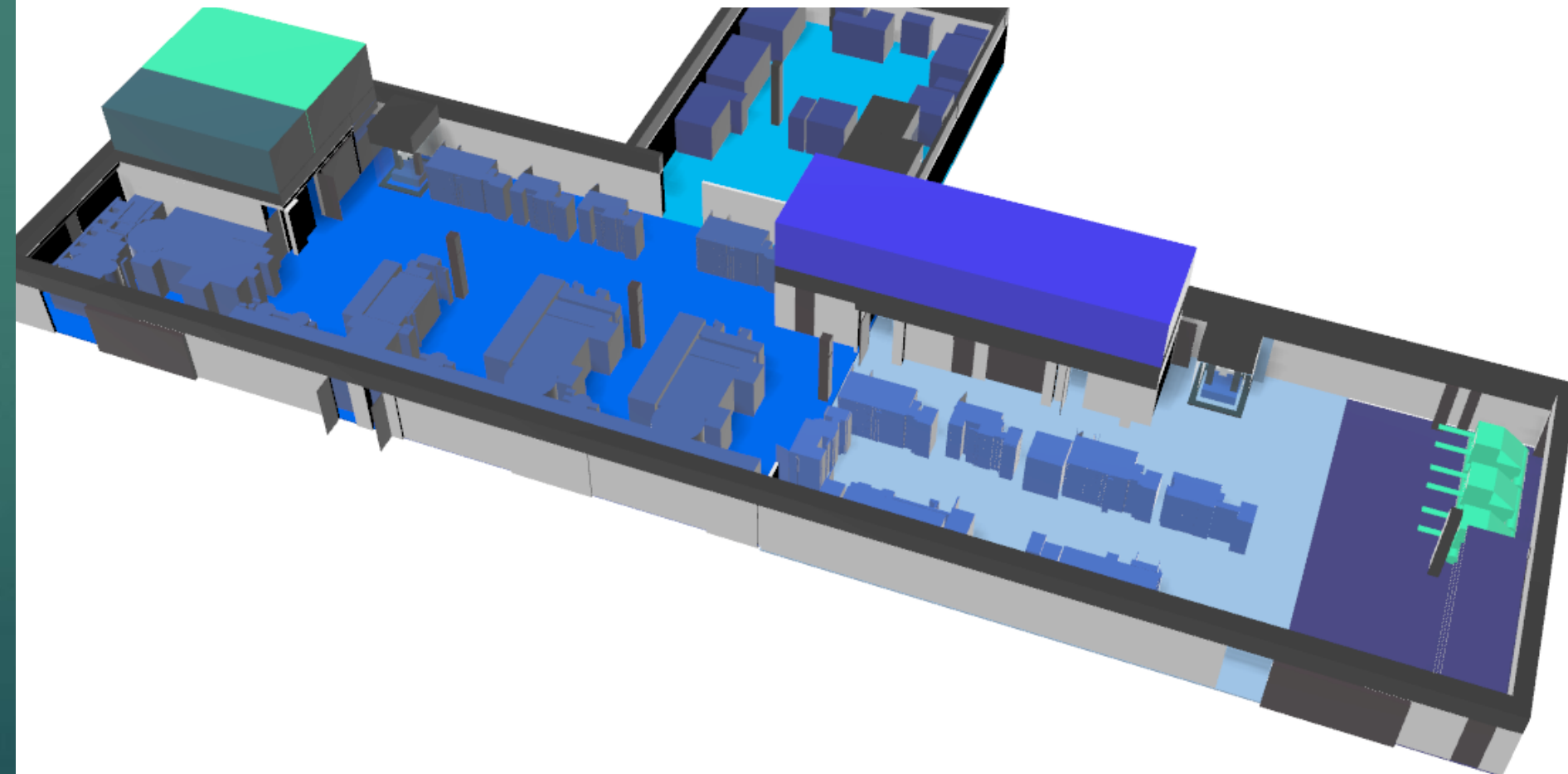

WE KNOW WHAT MECHANICAL MACHINING MEANS

- ▶ Passion for details
- ▶ Accuracy is our leitmotif
- ▶ From experts to experts
- ▶ Finest industrial mechanics brought to dental lab machines
- ▶ KAIZEN organization

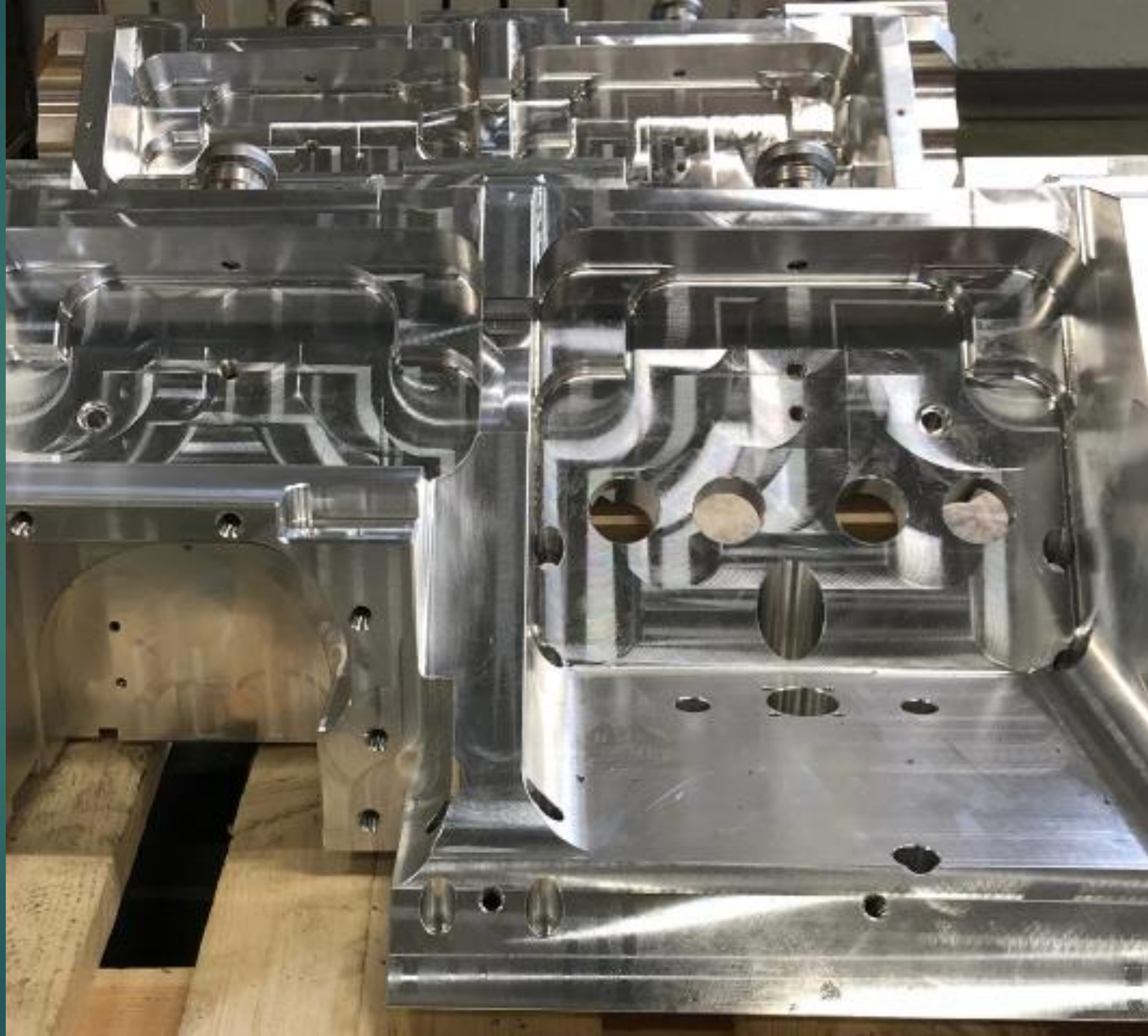

GLOBAL PRESENCE – ITALIAN HEART



Over 300 Dental Labs equipped with our Milling Solutions

BIG ENOUGH TO DARE, SMALL ENOUGH TO CARE!







- LAVORI
- UTENSILI
- GREZZI
- STATO**

Rack corrente	Utensile caricato	Posizione
Rack 3	60702391	12
Ciri mandrino	Feed	
35.000 rpm	1430 mm/min	
...	Data ultima calibrazione	

- CALIBRAZIONE MACCHINA
- CAMBIO RACK
- CAMBIO PINZA

DYAMACH MANUFACTURING SOLUTIONS

THE RIGHT SOLUTION FOR EVERYONE

▷ S1

▷ S1 Pro

▷ S1+

▷ T2

▷ S1





**IT ALL STARTS WITH A
VISION, AN IDEA, AN
INTUITION...**

A CONCENTRATE OF TECHNOLOGY

▷ S1



S1

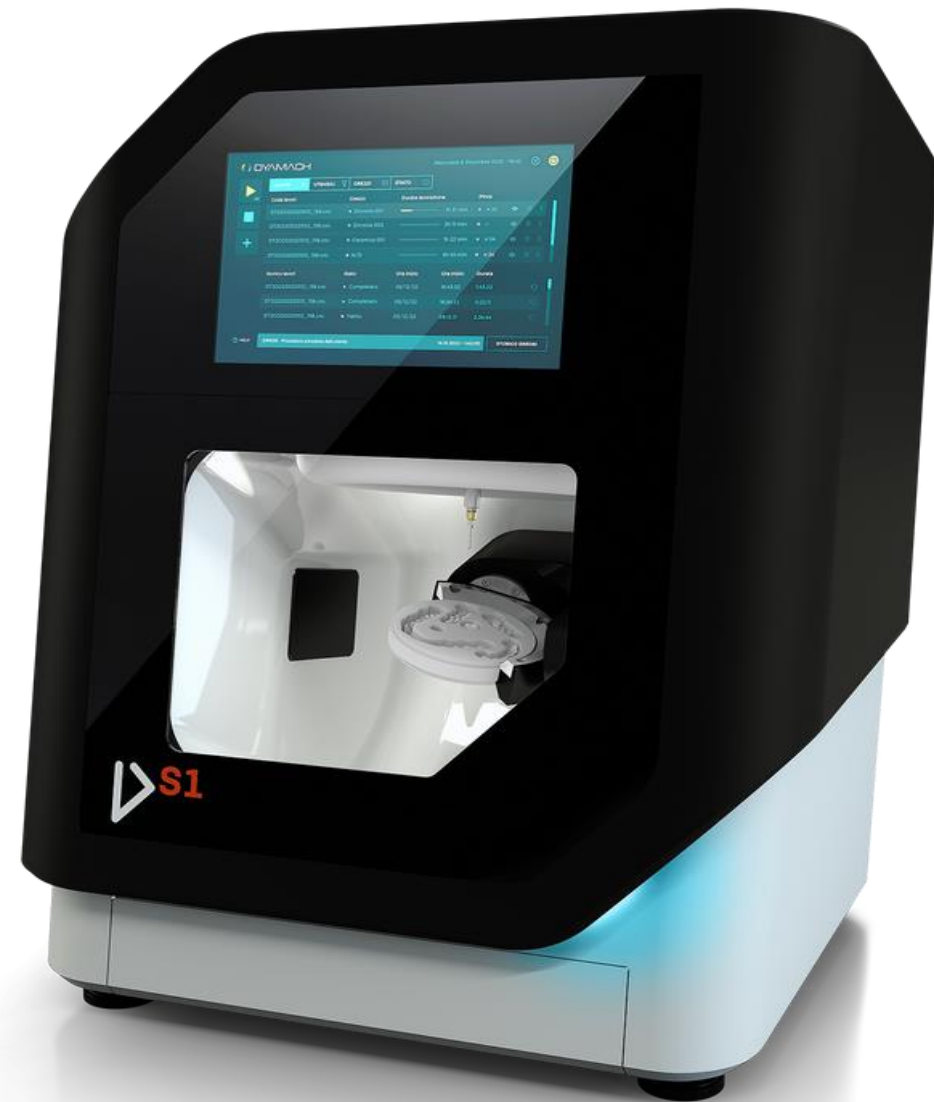

Our compact solution meets the need for **quick** and **reliable** results. Agile and precise, it is characterized by extreme accessibility.

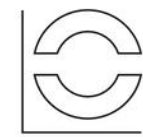

Size
52 x 54 x H 65 cm



Collet diameter
Ø 3mm / 4 mm



Weight
60 kg



Automatic calibration



Spindle power
0,75 kw



**Removable rack-type
tool magazine**
14 tools



Spindle speed
100.000 rpm

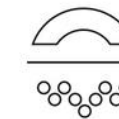

Integrated Panel PC

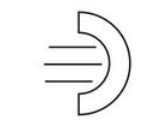

Machining type
Dry /

THE ANSWER TO ALL NEEDS



DS1+



DS1 PLUS is the answer to the need for proven **simplicity and performance** in processing materials such as **Glass-Ceramics** and **Laser Melting Repairs**.



Size
52 x 54 x H 65 cm



Weight
60 kg



Spindle power ›
0,75 kw



Spindle speed ›
100.000 rpm

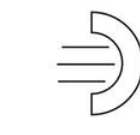

Machining type
Dry / Wet



Collet diameter
Ø 3mm / 4 mm



Automatic calibration



**Removable rack-type
tool magazine**
14 tools



Integrated Panel PC

UNIQUE SELLING POINTS

Design and usability

- ▶ ITALIAN DESIGN
- ▶ STAND-ALONE SOLUTION (BUILT-IN DISPLAY AND PC)
- ▶ INTEGRATED CAMERA FOR REMOTE MONITORING
- ▶ INTUITIVE AND USER-FRIENDLY INTERFACE
- ▶ VIDEO-TUTORIALS FOR REAL TIME OPERATIONAL SUPPORT
- ▶ MADE IN ITALY





UNIQUE SELLING POINTS

Technical features

- ▶ REMOVABLE PNEUMATIC DISK HOLDER WITH EXTREMELY ACCURATE HOUSING
- ▶ AUTOMATIC CALIBRATION SYSTEM
- ▶ RETRACTABLE TOOL-RACK
- ▶ PATENTED WATER SYSTEM (Automatic fluid adjustment)
- ▶ CASTED MONOBLOCK STRUCTURE WITH JUST 2 HOLES FOR TOOL-RACK AND SPINDLE
- ▶ MILLING CHAMBER SHAPE – OPTIMIZED EXHAUST SYSTEM
- ▶ BEST-IN-CLASS COOLING SYSTEM - 40 LITERS TANK WITH POWERFUL PUMP (only Ds1+)

AS1



AS1 is characterized by a tilting head spindle that allows for experimenting with unique milling strategies depending on the context. Tool precision and performance are guaranteed even on metals and hard materials.



Size
86 x 78 x H103 cm

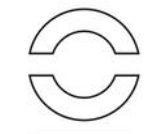

Weight
300 kg



Spindle power
1 kw



Spindle speed
60.000 rpm

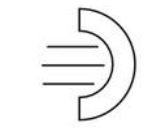

Machining type
Dry / Wet



Collect diameter
Ø 3mm / 4 mm / 6 mm



Spindle tilt degrees
- 90° / +30°



SLM secondary machining

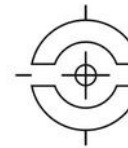

Automatic calibration



Removable rack-type tool magazine
18 tools

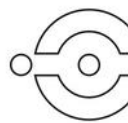

Rapid loading / unloading

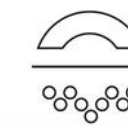

Integrated Panel PC

AS1 Pro

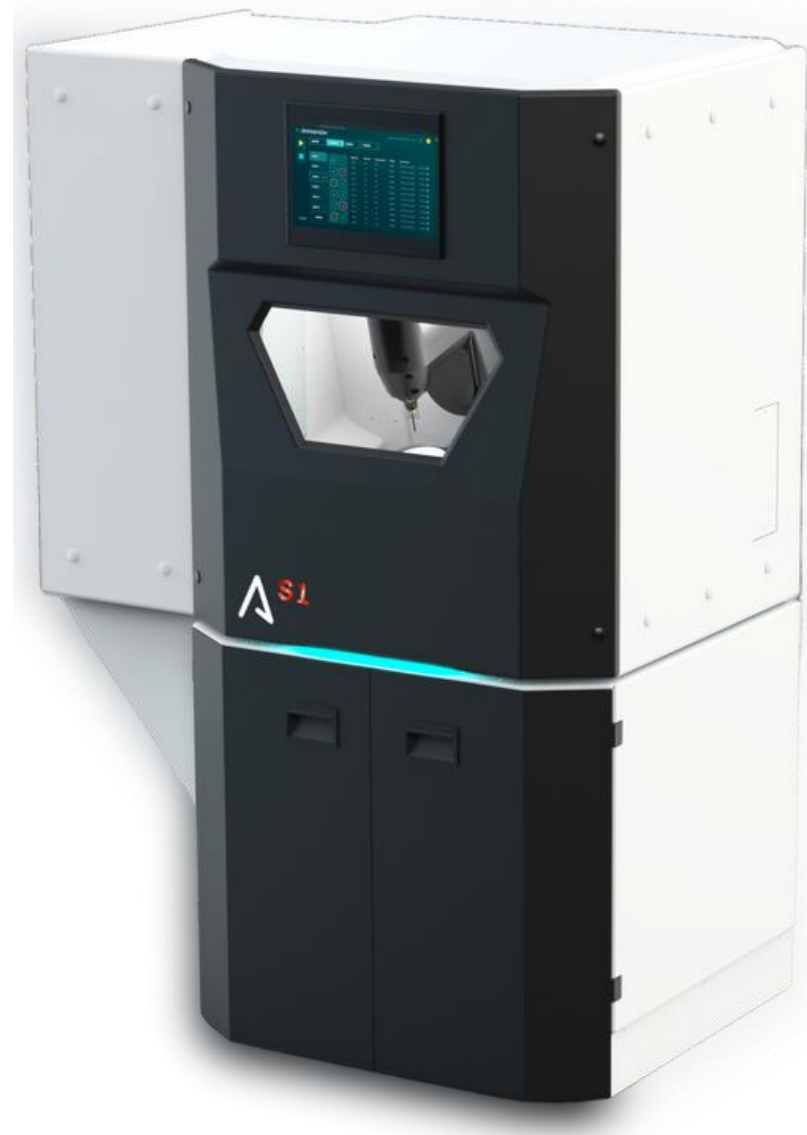

The performance of AS1 for extended work cycles with an 8-disc automatic loader.



Size
86 x 78 x H103 cm



Weight
300 kg



Spindle power
1 kw



Spindle speed
60.000 rpm

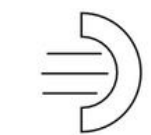

Machining type
Dry / Wet



Collect diameter
Ø 3mm / 4 mm / 6 mm



Spindle tilt degrees
-90° / +30°



SLM secondary machining



Automatic calibration



Removable rack-type tool magazine
18 tools

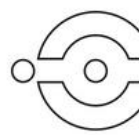

Rapid loading / unloading

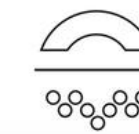

Integrated Panel PC

UNIQUE SELLING POINTS

Technical features

- ▶ REMOVABLE PNEUMATIC DISK HOLDER WITH EXTREMELY ACCURATE HOUSING
- ▶ AUTOMATIC CALIBRATION SYSTEM
- ▶ RETRACTABLE REMOVABLE TOOL-RACK
- ▶ CASTED MONOBLOCK STRUCTURE FOR EXTREME STABILITY
- ▶ MACHINE ACCESSIBILITY



UNIQUE SELLING POINTS

Technical features



▶ SPINDLE TILTING SYSTEM (+42° / -92°)

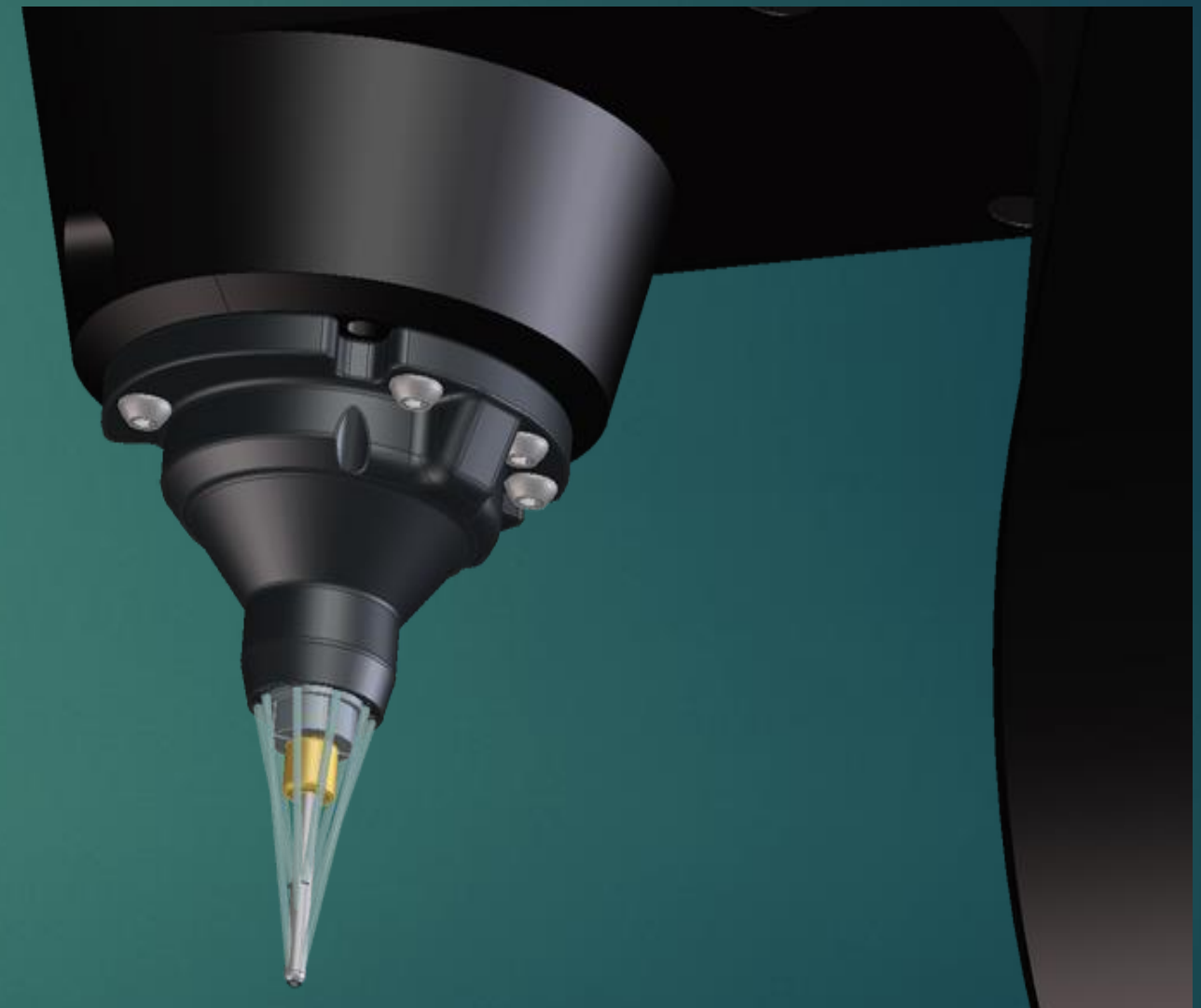

▶ PATENTED WATER SYSTEM (Automatic fluid adjustment)



DT2 is the continuous 5-axis CNC vertical milling machine, powerful and reliable.

The system's stability minimizes tool consumption and maximizes workpiece production speed



Size
125 x 70 x H160 cm



Collet diameter
Ø 3mm / 4 mm / 6 mm



Weight
590 kg

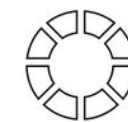

Carousel rack-type tool magazine
36 tools



Spindle power
2,6 kw



Rotative axis A



Spindle speed
50.000 rpm

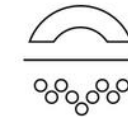

Integrated Panel PC



Machining type
Dry / Wet

UNIQUE SELLING POINTS

Technical features

- ▶ PATENTED ROTARY A AXIS
- ▶ 36 POSITIONS CAROUSEL RACK
- ▶ COMPACT MILLING CHAMBER FOR EXTREME STABILITY
- ▶ HIGH SPEED MACHINING
- ▶ REDUCED BURS CONSUMPTION
- ▶ MADE IN ITALY

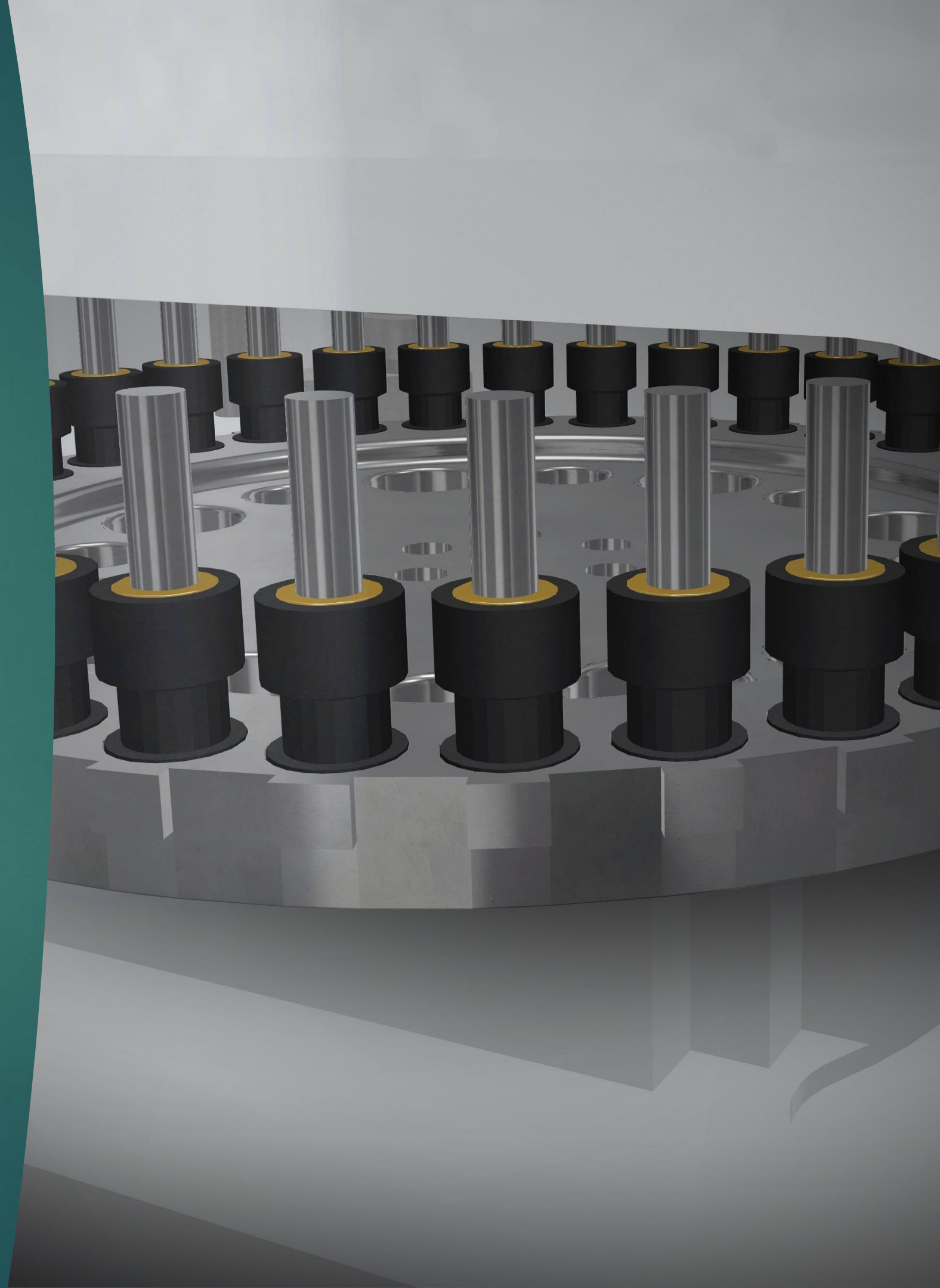

DYAMACH MARKETING STRATEGY



SOCIAL MEDIAS



COLLABORATIONS





EXHIBITIONS



Think global, act local!

**OFFICIAL
DISTRIBUTION NETWORK**



People make Business



Via Del Commercio 7/c
36065 - Mussolente (VI) - ITALY

+39 0424576231
+39 04241753418

info@dyamach.com

